

ASMPB SERIES STANDARD METRI-PACK BARBED PRESSURE TRANSDUCER

The ASMP series standard of high performance pressure transducers have been designed for the detection of fluid and air pressures in demanding motorsport and automotive applications.

The modular construction and programmable amplifier provide a fast delivery time for standard and custom configurations.

Pressure ranges are available between 1 bar to 5 bar absolute reference.

Industry standard 3-wire electrical connections allow configuration with most common ECU's and data logging systems.

The ASMP Series are race proven and can be found in many race formula around the world.

TECHNICAL SPECIFICATIONS

Pressure Datum	Absolute
Standard Pressure Ranges (Bar)	1, 2, 4 and 5
Safe Over Range	150% of range
Burst Pressure	>300% of range
Accuracy	±0.5% FS combined linearity & hysteresis (CNLH)
Thermal Effects	Zero ±0.04% FS/°C (Sensitivity ±0.04% of reading /°C)
Output	0.5V to 4.5V
Supply	5V (±0.5V) ratiometric or 8-16Vdc
Operating Temperature Range	-20°C to +135°C
Compensated Temperature Range	0°C to +125°C
Construction	Black anodised aluminium, alumina, Viton & FEP
Electrical Connection	Metri-Pack (Packard) 3 pin 150 series Connector
Process Connection	Barb to suit 4mm ID tube
Protection Class	IP67
EMC Protection &Vibration	EN 50082-1 and Mil-Std-810C, curve L, 20G
Weight	34g
Options	Mating half connector, cable assembly and labelling

KA Sensors adopts a continuous development program which sometimes necessitates specification changes without notice

**Sense
Measure
Control**

Features

- *Barbed Hose Fitting*
- *1 to 5 Bar Range*
- *Rugged Construction*
- *Lightweight*
- *Amplified Output*
- *±0.5% Accuracy*

Applications

- *Low Pressure*
- *Barometric*
- *Boost*
- *MAP*

Contact us

KA Sensors Ltd
Unit 14 & 15
The Old Malthouse
Springfield Road
Grantham
Lincolnshire
United Kingdom
NG31 7BG

sales@kasensors.com
+44(0)1476 568057

KAlibrated solutions for motorsport

kasensors.com

KAfigurator

ASMPB A 2000 4 A 2 A O V 000

Pressure Datum	Absolute	A							
Pressure Range	1 bar	1000							
	2 bar	2000							
	4 bar	4000							
	5 bar	5000							
Supply Voltage	5V ratiometric		4						
	8-16V		5						
Accuracy (CNLH)	±0.5% of Full Scale			A					
Accuracy (Thermal Zero Shift)	<±0.04% /Span /°C				2				
Electrical Connection	Metri-Pack 150 Series Conn.					A			
Process Connection	Barb to suit 4mm ID tube						O		
O-Ring Material	Viton							V	
	EPDM								E
Special Codes	None								000

The KA configuration tool is used to specify a standard KA Sensor, other options are available.

MECHANICAL DETAILS

Dimensions in mm

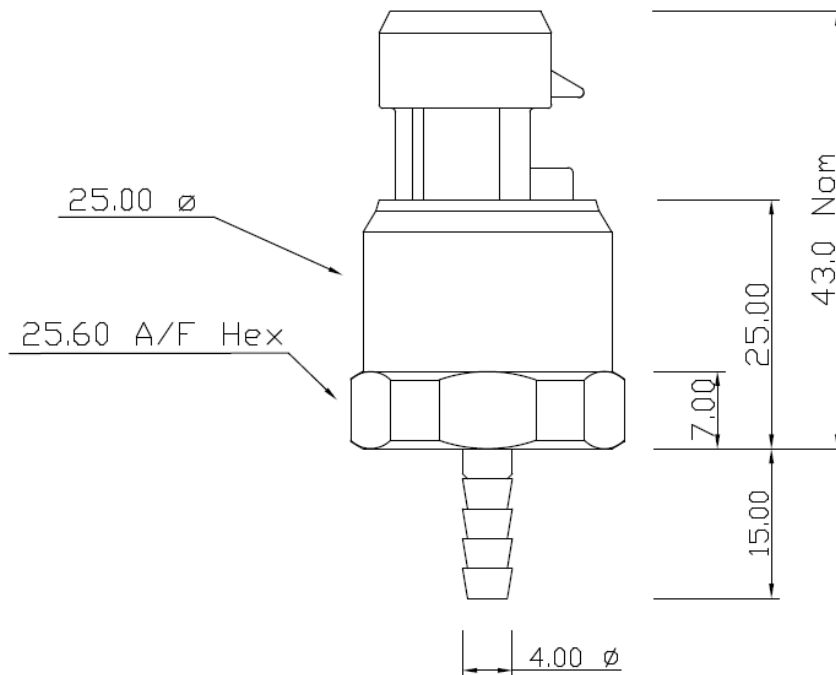

CONNECTION DETAILS

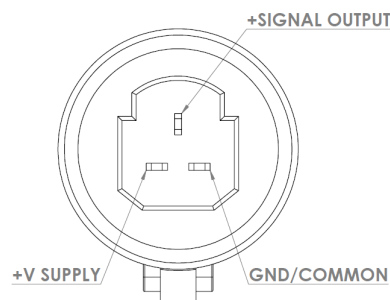
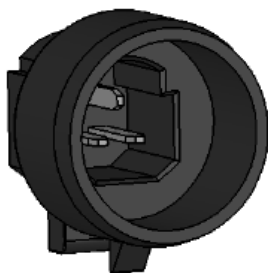

**Sense
Measure
Control**

Sensors for

- Temperature
- Acceleration
- Pressure
- Position
- Torque
- Speed
- Angle
- Force

Services for

- Data Logging
- Telemetry
- Controls
- Wiring
- Design

KA Sensors are

- Engineering led
- Confidential
- Experienced
- Responsive
- Dynamic
- Friendly

KAlibrated solutions for motorsport

kasensors.com